



GOLDEN RETRIEVER CLUB OF AMERICA

Tuesday, October 27, 2009

WHEATLAND GOLDEN RETRIEVER CLUB OF WICHITA

Wednesday, October 28, 2009



CHISHOLM TRAIL EXPO CENTER
111 W. Purdue, Enid, OK 73701 - (580) 237-0238
Agility Trial Located in the Pavilion

AGILITY JUDGING PROGRAM

Welcome to the GRCA National Specialty and Wheatland Golden Retriever Club of Wichita Agility Trials. We are thrilled to have you and hope you have a wonderful time! There are a lot of exciting activities going on, so please feel free to visit our vendors and watch other events. Please read the information in this judging program carefully as it will probably answer most questions you might have.

ARRIVAL/SETUP/CRATING

These trials are being held indoors on a packed dirt surface. Exhibitors may move in for crating at any time after 12:00 noon on Saturday, October 24. The building will be locked and a security guard will be on duty overnight. You may leave dogs crated overnight **at your own risk**. A dedicated crating area will be designated on the west and south sides of the Red Dirt Arena for Agility exhibitors. No grooming is allowed in this area. For the most convenient access to the agility area, please use the south doors of the Chisholm Trail Expo Center. The concrete walkway that connects the grooming area and the Coliseum may NOT be used for crating and must be kept clear to allow traffic to flow smoothly.

CHECK-IN

Self-service check-in begins at 7:00 am on Tuesday and Wednesday. **Check-in on Wednesday is not required unless you are entered only on Wednesday.** If you submitted a photocopy of your dog's official AKC Jump Height card when you entered, you will pick up your handler envelope containing armband stickers for both days from the check-in table. If your dog needs to be measured, or you did not send a copy of your dog's official AKC Jump Height card, your dog must be measured, or its jump height card must be inspected before you receive your armbands. If your armbands are not in the check-in box, please see the Trial Secretary.

HEIGHT CARD AND MEASURING INFORMATION

Any dogs that do not have official AKC Jump Height Cards **MUST** be measured **before they compete**. If you didn't send a copy of your height card in with your entry, please check in with the Trial Secretary before your run to show your height card and pick up your armbands. There will be a VMO on site for official measuring. She will measure **ALL** dogs who do not have their official AKC Jump Height cards, **REGARDLESS** of jump height. To have your dog(s) measured, the VMO will provide forms that you will fill out, and **you will need the following: (1) your dog's official registered name, (2) birthdate, and (3) AKC registration number or ILP number**, so please bring this information with you. Any dog that is measured taller than the jump height in which it was entered will be moved to the higher jump class immediately. Any dogs running in the FAST classes should be measured before judging commences at 8:00 a.m. both days.

RUNNING ORDERS & COURSE MAPS

Please take **ONE** copy of course maps so we will have sufficient copies for every exhibitor. Running orders will be posted.

JUDGES

Bonnie Drabek, Aurora, IL
Tuesday: All Standard, Novice and Open FAST Classes
Wednesday: All JWW, Excellent FAST Classes

Dan Butcher, Portland, OR
Tuesday: All JWW, Excellent FAST Classes
Wednesday: All Standard, Novice and Open FAST Classes

DAY-TO-DAY MOVE-UPS

If you complete a title at Tuesday's trial and would like to move up, please submit a move-up form no later than 30 minutes following the close of Tuesday's trial. Move-up forms (printed on green paper) will be available at the check-in table. Dogs moving up will run at the end of the new class. You may not move up on Wednesday if you do not complete a move-up form and turn it in on Tuesday no later than 30 minutes following the last run.

ARMBANDS

Armbands (stickers) **MUST** be worn. You may not compete if you are not wearing armbands (sticker) for each dog entered.

CHANGES TO POSTED RUNNING ORDER

We try very hard to separate multiple-dog handlers between their runs. If, after reviewing the posted running order at the trial, you feel you need extra time between your runs, you may ask the Gate Steward to move your **FIRST** dog higher in the running order, and/or you may request to move your **NEXT** dog lower in the running order. AKC rules state, however, that at **NO TIME** may you switch the running order of the dogs, i.e., move the second dog to run **BEFORE** the first.

VETERINARIAN

ON SITE AT THE EXPO CENTER
Ronald Laughlin, DVM

ON CALL FOR AFTER HOURS EMERGENCIES:
Wheatland Animal Clinic - 5805 W Garriott
(580) 237-1245

DVMs - Lenz, Chambers, Weinand
Call and leave message and call back number;
Answering service will contact the Vet and he will return your call.

THE TAIL GATE PARTY

Tuesday, October 27
In the Grooming Room at designated grooming places
15 MINUTES FOLLOWING THE CONCLUSION OF TUESDAY'S CONFORMATION JUDGING

Everyone Welcome!

This is a no-host event. Bring finger food-type snacks and/or beverage of your choice, find an available designated grooming table in the designated area and put your contributions out. Be very careful with bringing any special serving platters, as some things get lost in clean-up. We recommend disposable platters. If you bring a crock-pot type dish, please be responsible for taking it away at the end of the event. The club will provide small plates, beverage cups, non-alcoholic beverages, and napkins. Bring your snacks, appetizers, and beverages (beer and wine are very popular. There might be a martini or two being shaken, not stirred. Let the party begin!

AWARDS

AWARDS – GRCA National Specialty and Wheatlands Golden Retriever Club of Wichita

Ribbons/Rosettes: Rosettes will be awarded to the 1st through 4th place Dog; in each class in each jump height. Qualifying ribbons will be awarded to all dogs receiving a qualifying score. Dogs must qualify to receive placement ribbons. We will have special New Title rosettes along with rosettes for those earning a MACH or PAX (also includes a MACH/PAX pole).

SPECIAL AWARDS – GRCA National Specialty

- **Standard and JWW classes:** 1st Place: 9" x 13" bronze colored custom casting of event logo by Ida Marino; 2nd through 4th: 4" x 4" logo tile
- **Fast Classes:** 1st Place through 4th Place: 4" x 4" logo tile
- **All Agility Class Winners:** Purina Pro Plan slip lead offered by Purina
- **High Scoring Qualifier** - Mounted Hand-Colored Custom Casting - awarded to the dog in both Excellent B standard and Excellent B Jumpers with Weaves in Regular Height Divisions with the fastest combined time.

DIRECTIONS TO THE SHOW SITE

CHISHOLM TRAIL EXPO CENTER
 111 W. Purdue, Enid, OK 73701
 (580) 237-0238
Agility Trial Located in the Pavilion

From the East - Take Hwy 412 to the exit for 30th Street/NOC . At the Stop sign turn Right (north). Go approximately 4 miles and follow the curve to the left. You are now on Willow Street. Go to the 4-way stop at 4th St and turn right (north). Go to Purdue St (about 2 miles) - turn left (W) the Expo Center is on the left (south side).

From I-35 North or South - Exit West on Hwy 412 to Enid and follow directions above to either Show or Field sites.

From the South on Hwy 81 - You will go through several small towns - DO NOT SPEED through them at any time - You will see a sign on the right that says "Welcome to Enid" - continue on Hwy 81 (Van Buren St) approx. 10 mi. to Purdue Street - turn right (east) at the Stop Light and the Expo Center is 1/2 mile on the right (south side)

From the West on Hwy 412 - Stay on Hwy 412 (W Owen K Garriott) to the Intersection of Hwy 412 & 81 (Garriott & Van Buren). Turn left (north) and follow above directions for those coming from the south on Hwy 81.

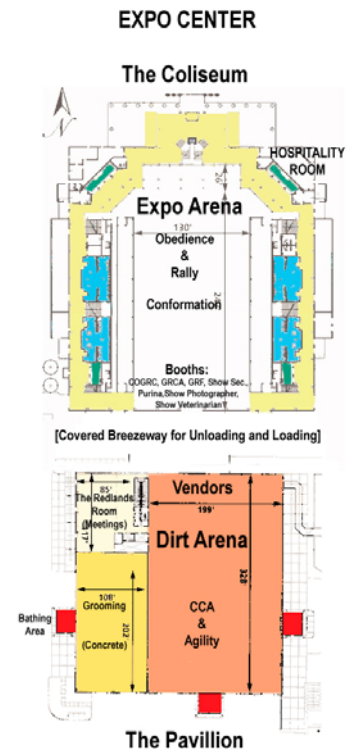
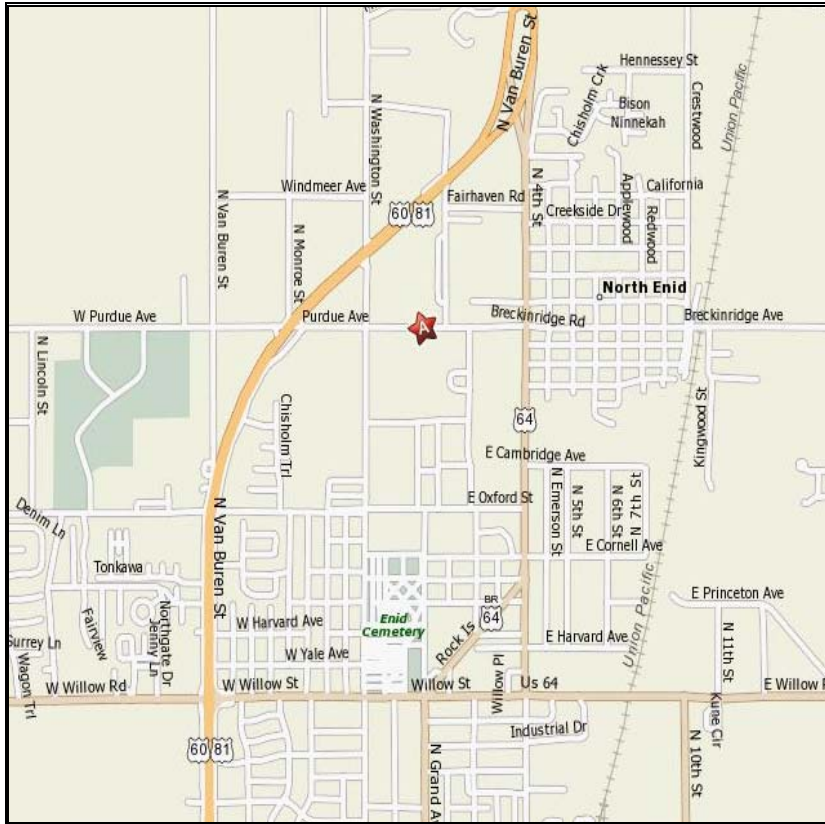

RUNNING ORDER

AGILITY IS LOCATED IN THE PAVILION

GOLDEN RETRIEVER CLUB OF AMERICA			
TUESDAY, OCTOBER 27, 2009 (310 TOTAL RUNS)			
SELF CHECK-IN BEGINS AT 7:00 AM; RUNS BEGIN AT 8:00 AM			
RING 1 - JUDGING STARTS AT 8:00 AM BONNIE DRABEK, JUDGE (163 RUNS)		RING 2 - JUDGING STARTS AT 8:00 AM DAN BUTCHER, JUDGE (147 RUNS)	
FAST Open	Walk/run together 11 dogs	FAST Exc 20" 24" 26"	Walk/run together 23 dogs
FAST Novice	Walk /run together 26 dogs	JWW Exc A/B 16" - 20"	Walk/run together 50 dogs
Standard Exc A/B 16" - 20"	Walk/run together 48 dogs	JWW Exc A/B 24" - 26"	Walk/run together 23 dogs
Standard Exc A/B 24" - 26"	Walk/run together 26 dogs	JWW Open 16" - 26"	Walk/run together 10 dogs
Standard Open 16" - 26"	Walk/run together 13 dogs	JWW Novice 16" - 26"	Walk/run together 41 dogs
Standard Novice 16" - 26"	Walk/run together 39 dogs		
These preliminary running orders are contingent on move-up changes not yet received			

WHEATLAND GOLDEN RETRIEVER CLUB OF WICHITA			
WEDNESDAY, OCTOBER 28, 2009 (247 TOTAL RUNS)			
SELF CHECK-IN BEGINS AT 7:00 AM; RUNS BEGIN AT 8:00 AM			
RING 1 - JUDGING STARTS AT 8:00 A.M. DAN BUTCHER, JUDGE (126 RUNS)		RING 2 - JUDGING STARTS AT 8:00 A.M. BONNIE DRABEK, JUDGE (121 RUNS)	
FAST Open	Walk/run together 10 dogs	FAST Exc 20" 24" 26"	Walk/run together 19 dogs
FAST Novice	Walk/run together 14 dogs	JWW Exc A/B 16" - 20"	Walk/run together 45 dogs
Standard Exc A/B 16" - 20"	Walk/run together 43 dogs	JWW Exc A/B 24" - 26"	Walk/run together 20 dogs
Standard Exc A/B 24" - 26"	Walk/run together 21 dogs	JWW Open 16" - 26"	Walk/run together 9 dogs
Standard Open 16" - 26"	Walk/run together 12 dogs	JWW Novice 16" - 26"	Walk/run together 28 dogs
Standard Novice 16" - 26"	Walk/run together 26 dogs		
These preliminary running orders are contingent on move-up changes not yet received			

See the Catalog, Judging Program, and Results at www.ntxagility.com

VIEW THE RESULTS AFTER THE TRIAL AT

<http://www.cogrc.org/national> on the "Results" Page

AND AT

<http://www.ntxagility.com>